

-
.

- .24

: 4 -
):

2

:

4

3

108

4

:

01

2020

1.

4

2

-5.	6 - 6 - 6 - -
-1.	6 - - - 6 6 - -

--	--

3.

4.

1		1	1	-	-
2		4		2	2
3		4		2	2
4		4		2	2
5		5	1	2	2
6		5	1	2	2
7		5	1	2	2

8		5	1	2	2
9		5	1	2	2
10		5	1	2	2
11	-	4	1	2	1
12		4	1	2	1
13		5	1	2	2
14		5	1	2	2
15		4	1	2	1
16		4	1	2	1
17		4	1	1	2
18		3	1	1	1
19		3	1	1	1
20		2		1	1
		27	-	-	27
		108	16	34	31+27

1

-

2.

3.

4.

5.

6.

7.

8.

9.

10.

11.

12.

13.

14.

15.

16.

17.

18.

19.

20.

-

.

-

0

-

-

1

-

- - - - -

-30.

1

- - - -

2

- - - -

3-8

$$\operatorname{tg} \alpha_{AB} = \frac{Y_B - Y_A}{X_B - X_A} = \dots; r_{AB} = \dots;$$

$$\alpha_{AB} = \dots; d_{AB} = \sqrt{(Y_B - Y_A)^2 + (X_B - X_A)^2} = \dots$$

Microsoft Exel

- 2.
- 2.

		Отсчеты по рейкам		средние	Отметки точек, м.
1	102 1	1560 6246	1362 6050		
2	1 2	0424 5111	2551 7235		
3	2 3	2001 6687	2518 7204		
4	3 4	2203 6887	1194 5882		
5	4 5	1650 6336	0717 5405		
6	5 102	2435 7123	1936 6622		
$\Sigma = \Sigma =$ $\Sigma - \Sigma =$				$\Sigma h =$	$\Sigma h =$

$$f_h = \Sigma h =$$

$$f = \sqrt{\quad}$$

- 3.
- 3.1.

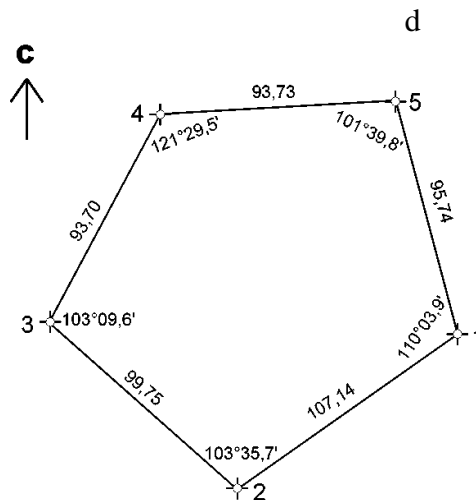

- 3.2.
- 3.3.

B C E

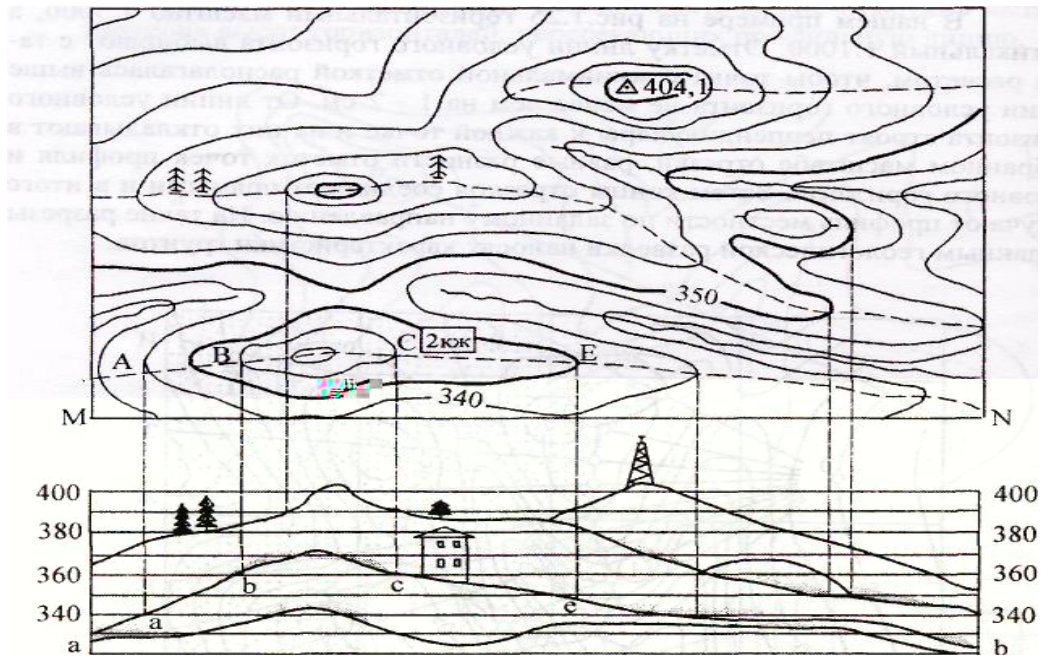

- -14

ABCD

AB AD

$$x_a = (x_{max} + x_{min}) / 2;$$

$$y_b = (y_{max} + y_{min}) / 2,$$

x_{max} y_{max} x_{min} y_{min}

b

x_a y_b

x' y'

$$x' = 448$$

$$y' = 478$$

d x' a y' D D

d d' d d ' , d d'

y

2.

Ax_i Ay_i

m mn mnkc Ax₁ = 432,88¹ y₁ h f h

15-16

	1 2		
-	1 2		

17

1.

-

!

2

--

1).

2).

XVII
XVII
XVII

3).

XIX
XIX
XIX

4).

—

-

5).

6).

7).

8).

1) ~~12~~

—

..

1.

2.

3.

-

-

-

4.

5.

6.

7.

8.

9.

- 98-
- 74-

- 51-
-

-

21.

1. 20. 246 (3 - /)

ISBN 978-5-534-10497-4.
URL: <https://urait.ru/viewer/inzhenernaya-geodeziya-452583#page/2>

1. 3.
2.

- 3.
- 4.
- 5.

2008.

3

1. <http://www.geoprofi.ru>
2. <http://www.2gis.ru>
3. <http://www.gisa.ru>
4. <http://journal.miigaik.ru/>
5. <http://www.credo-dialogue.com/>
6. <http://www.rosreestr.ru>
7. <http://www.67.rosreestr.ru/>
8. <http://www.vishagi.ru>
9. <http://www.fccland.ru>

4

KasperskyEndpointSecurity

FB6-161215-133553-1-6231

Microsoft Open License, 49463448 :

1. MicrosoftWindows Professional 7 Russian
2. Microsoft Office 2010 Russian

9

- SMART;
- KraftwayKC 41
-
- EpsonGT-20000
-
- GPS Garmin;
-
- Planix 10S;
- BOSCH;
- TrimbleDiNi;
- SETLAL24;
-
-
-
-

-
-
-
-

S6;
TS3-

